



*Operating / Service  
Manual*

**IMPORTANT:** *Read all instructions before assembling or using this device.*

For decades, JEDMED Instrument Company has built its reputation on principles of quality, integrity, innovation and value. Continuous research and development coupled with exceptional customer service and a world-class quality system has placed JEDMED as an industry leader.

As always, our focus remains on you, our valued customer. Building rewarding and lasting relationships is the cornerstone of JEDMED's business philosophy. JEDMED is committed to delivering reliable and cost-effective solutions to medical professionals everywhere.

The employee-owners of JEDMED would like to take this opportunity to thank you for all your support. We are pleased and proud to serve the ever-changing medical community.

Sincerely,

**JEDMED**



**CONTENTS**

<b>Section</b>	<b>Page</b>
<b>OPERATING</b>	
Precautions.....	4
Description.....	5
Unpacking .....	5
Parts Identification.....	6-9
Options.....	10-11
Assembly.....	12
Operation.....	13-15
Cleaning / Disinfection.....	16-17
Maintenance.....	16
Reorder Information.....	18-19
Specifications.....	20-22
<b>SERVICE</b>	
Information .....	24
Troubleshooting.....	25
Diagrams.....	26-27

*Note: Specifications subject to change without notice.*

**PRECAUTIONS**

The following conventions are used throughout this manual:

-  **WARNING** Alerts user to the possibility of **PERSONAL INJURY**.
-  **CAUTION** Alerts user to the possibility of **DAMAGE to the EQUIPMENT**.
-  **NOTE** Alerts user to **PERTINENT FACTS or CONDITIONS**.

 **NOTE**

Photos throughout this manual depict the standard Classic CSC Cabinet for simplicity. The stainless steel version of the cabinet is equivalent except as indicated.

---

## Safety Precautions

- Allow operation only by qualified personnel.
- Do not leave device(s) operating while unattended.
- **Always use "Universal Precautions" when handling potentially infectious material.**
- **Always clean, disinfect and sterilize equipment between patients**
- **Use care when introducing pressurized medications to patients.**
- **When using fiberoptic light sources, keep flammables away from light port, fiberoptic cable ends and endoscope tip.**
- Disconnect from power before cleaning, servicing or storing.
- Do not allow liquid to enter any parts of this device.
- Specula and other instruments may pose choking hazard for small children.
- Always replace fuse(s) with same type and rating.

**DESCRIPTION**

The JEDMED Classic CSC ENT Cabinet is a cost-effective workstation for the otolaryngic specialist. Its proven design has remained the industry standard for decades.

The contemporary look of the Classic CSC will enhance the appearance of any exam room. Several versatile color choices are available making it easy to coordinate with most any decor.

Standard configuration comes complete with all pumps, tubing, canisters, and spray bottles necessary for a basic ENT set-up. A variety of options are available allowing the cabinet to be customized to the user's specific work-style. Fully updated, the Classic CSC incorporates all user-friendly, low-voltage controls.

A stainless steel version of the cabinet is also available for users who prefer this timeless material. It is equivalent in form and overall dimensions to the standard Classic CSC.

The Classic CSC ENT Cabinet is a quality-designed and manufactured medical device. Given reasonable care, this product will provide many years of trouble-free service.

**UNPACKING****SHIPPED IN CARTON:**

1. Cut bands holding carton together.
2. Remove top end cap.
3. Remove main carton tube.
4. Carefully lift cabinet off of bottom end cap (skid) and place on desired floor location (2 people required).
5. Carefully cut stretch-wrap away from cabinet.

**➤ NOTE**

Any shipping damage should be documented and reported immediately to the carrier or JEDMED.

**SHIPPED VIA MOVING VAN:**

1. Carefully cut stretch-wrap away from cabinet.

**PARTS IDENTIFICATION**

**Main Cabinet**

(right side)

- 1. Bottle shelf
- 2. Work surface
- 3. Tubing hanger
- 4. Pressure connection
- 5. Suction tubing
- 6. Pressure tubing

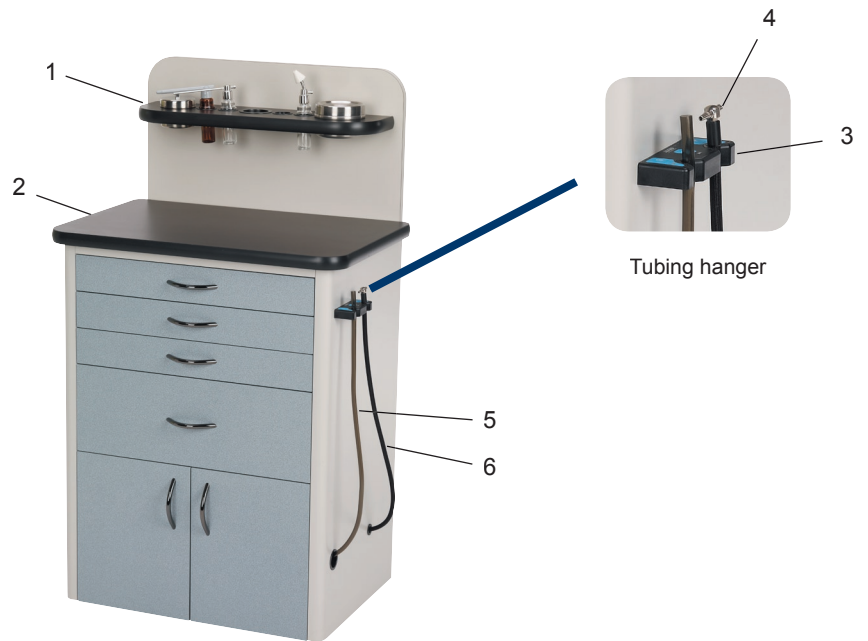

**Main Cabinet**

(left side)

- 1. Instrument drawer
- 2. Storage drawer
- 3. Pump compartment & trap canister
- 4. Control unit
- 5. Cord cover



**PARTS IDENTIFICATION**

**Control Unit**  
(top view)

- 1. Power input
- 2. Main power switch
- 3. Power indicator
- 4. Auxiliary indicator
- 5. Pressure indicator
- 6. Suction indicator

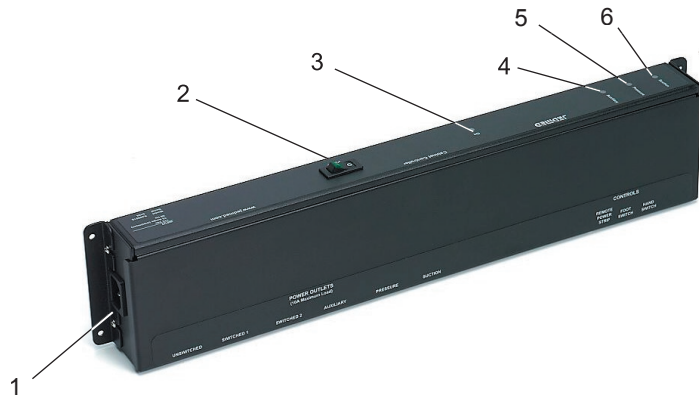

**Control Unit**  
(bottom view)

- 1. Unswitched outlet
- 2. Switched 1 outlet
- 3. Switched 2 outlet
- 4. Auxiliary outlet
- 5. Pressure outlet
- 6. Suction outlet
- 7. Remote power strip connection
- 8. Footswitch connection
- 9. Tubing hanger (hand switch) connection

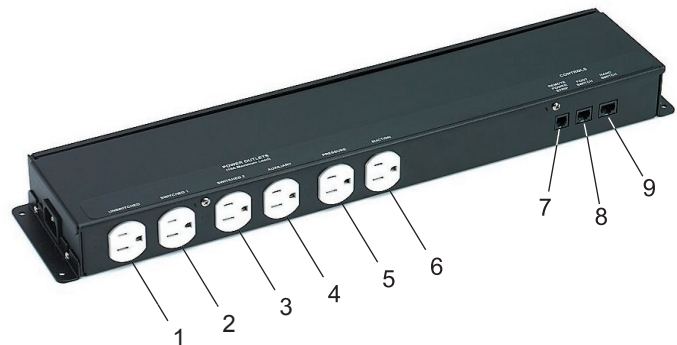

**Tubing Hanger (hand switch) Controls**

- 1. Suction switch
- 2. Suction indicator
- 3. Auxiliary switch
- 4. Auxiliary indicator
- 5. Pressure switch
- 6. Pressure indicator
- 7. Internal switches (automatic version only)

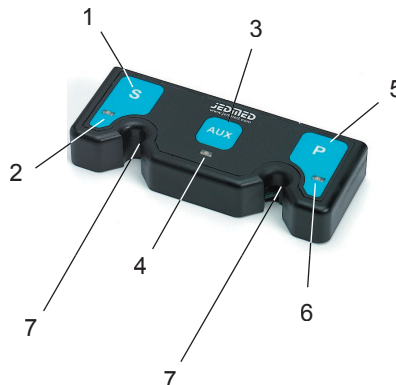

**PARTS IDENTIFICATION**

**Pump Compartment Components**

- 1. Pressure pump
- 2. Suction pump
- 3. Trap canister



Pump compartment located in base of cabinet

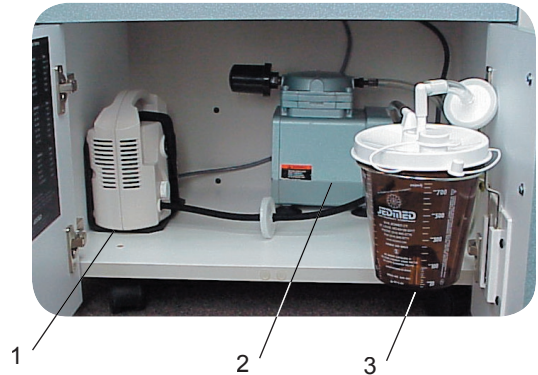

**Suction Trap System**

- 1. Trap canister & lid
- 2. Patient tubing
- 3. Suction tubing (to pump)
- 4. Hydrophobic filter
- 5. Elbow fitting

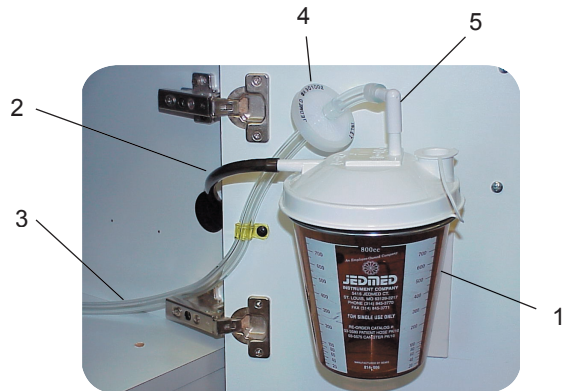

Trap canister configuration

**Suction Pump Detail**

- 1. Suction tubing
- 2. Muffler



Suction pump



**PARTS IDENTIFICATION**

**Pressure Pump Detail**

- 1. Power switch
- 2. Power cord
- 3. Intake filter
- 4. Pressure tubing
- 5. Hydrophobic filter (pressure)
- 6. Securing strap
- 7. Foam pad

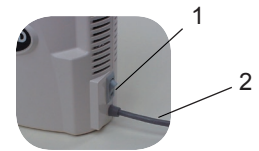
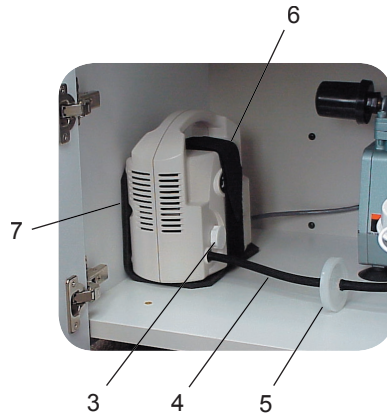

Pressure pump (right side)

---

**Accessories**



Powder Blower  
#175



Nebulizer  
#180



Atomizer  
#286



3" Cotton  
Container



4" Gauze  
Container

**PARTS IDENTIFICATION - Options**

Option

**Standing Riser (10")  
with drawer**

➤ **NOTE**  
Not available on stainless steel version.



Riser Drawer



Cabinet on Riser



Option

**Flip-Up Shelf**

➤ **NOTE**  
Not available on stainless steel version.



Retracted



Extended



Option

**Remote Footswitch**



Footswitch Option



Plugs into rear of control box

PARTS IDENTIFICATION - Options

Option

Automatic Switching Tubing Hanger (pressure & suction)

Pressure or suction pumps start automatically when tubing is lifted out of hanger bracket.



Automatic switching option

Option

Otoscope Recharger Unit (Welch Allyn®)

Rechargeable handle unit for otoscopes.



Otoscope Option

JEDMED K2 Recharger

Works with traditional Welch Allyn® 2.5V or 3.5V rechargeable handles.



Integrated

OR



Stand-Alone

Option

Remote-Controlled Power Strip

Remote power strip is controlled by cabinet power. When cabinet control box is switched off, power to remote outlet is also shut off. Plug microscope and/or power chair into remote power strip to keep children from tampering with sensitive equipment while physician is out of the room.

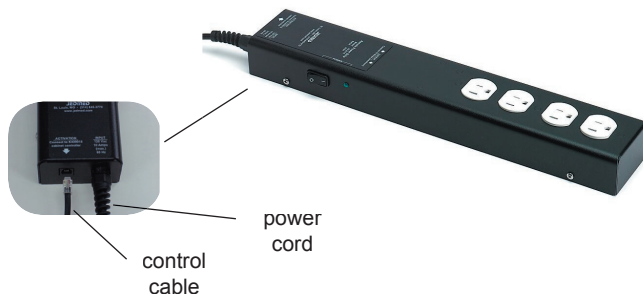

control cable  
power cord



Control cable plugs into rear of control box

**ASSEMBLY INSTRUCTIONS**

**INSTALL TRAP CANISTER**

- 1. Place lid on canister and press to seal securely.
- 2. Slip canister with lid into metal support ring.
- 3. Attach tapered elbow fitting (on end of pump tubing) to top of canister.
- 4. Attach dark gray patient tubing to "Patient" inlet on canister.



Trap canister

**INSTALL SUCTION PUMP**

- 1. Attach fittings to pumps (if required).
- 2. Place pump in cabinet.
- 3. Connect suction tubing (clear) to suction pump inlet.
- 4. Plug pump into "suction" receptacle located on bottom of control box.

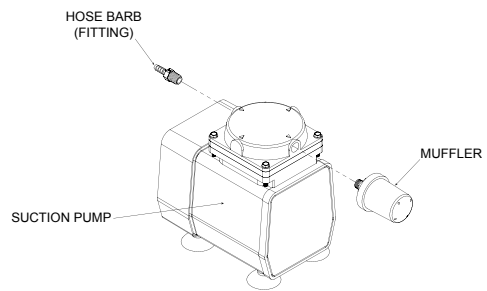

Assembly

**NOTE**  
Pressure pump comes pre-installed in cabinet.



Tubing Connection



Pump placement

**INSTALL OPTIONS**

Options are normally supplied fully assembled and installed at the factory. If options are ordered after initial cabinet purchase, follow instructions received with each option.

**DEVICE OPERATION**

**Controls**

**Warning**  
Possible explosion hazard if used in the presence of flammable anesthetics.

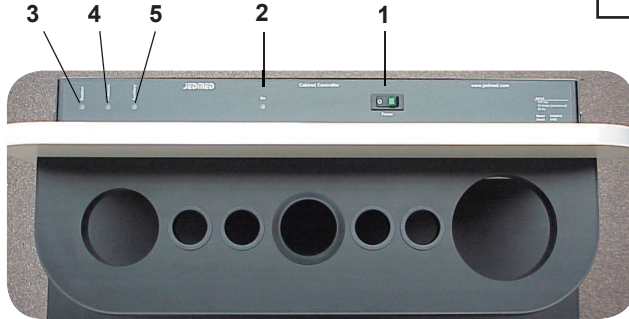

Top view

- 1. Power Switch (main)**      Shuts off all AC power to the cabinet except "unswitched" receptacle on bottom of control box. "Unswitched" receptacle may be used for rechargeable otoscope unit or other device which requires power even if control box is shut off.
- 2. Power Indicator**            Indicates when power to cabinet is switched "ON"
- 3. Suction Indicator**            Indicates when suction pump is energized.
- 4. Pressure Indicator**           Indicates when pressure pump is energized.
- 5. Auxiliary Indicator**          Indicates when auxiliary device is energized. "AUX" receptacle is located on bottom of control box.

**Typical Use**



Hand Switch



Footswitch

- Depress "P" on hand switch to start pressure pump. Pressure illuminator lights and pump runs.
- Press "P" again to stop pump.
- Pump may be optionally controlled using footswitch or automatic tubing hanger. Regardless which switch turns pump on, indicators on all devices will light. Likewise, pump may be turned off by using any control (hand switch, footswitch or automatic tubing hanger).
- Suction pump and Auxiliary outlet operate similarly.
- Various options may be plugged into Auxiliary outlet and be controlled via "AUX" switch (power limit: 2 amps).

**DEVICE OPERATION**

**SPRAYING (Pressure)**

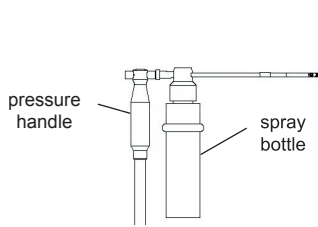

Connect bottle  
(Tapered Luer fitting)

1



Turn on pressure

2

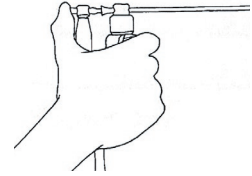

Begin spraying  
(Partially cover bleeder hole with thumb)

3

**Warning**  
Always exercise care when introducing pressurized medications onto the site. Use only enough pressure to accomplish the task.

**ASPIRATING (Suction)**

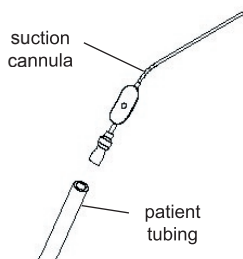

Install cannula

1



Turn on suction

2

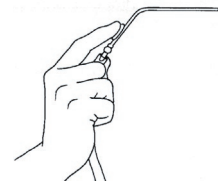

Begin aspirating  
(Cover bleeder hole with index finger to draw vacuum)

3

**DEVICE OPERATION**

**REPLACEMENT OF TRAP CANISTER & PATIENT TUBING**



**1** Disconnect Pump Tubing



**2** Cap Port (optional\*)



**3** Disinfect Patient Tubing



**4** Cap Patient Tubing



**5** Carefully Pass Tubing Through Cabinet



**6** Remove & Discard Properly

\*Capping canister pump port is optional. An internal hydrophobic filter blocks liquids from leaking; nevertheless, JEDMED recommends capping this port. However, the patient tubing port on the canister contains no such filter and port must be capped to avoid leakage.

**➤ NOTE**

To avoid contaminating cabinet, do not contact opening or cabinet wall with tubing or gloves as tubing is passed through. If contacted, disinfect area immediately.

**⚠ Warning**

Aspirated bodily fluids are considered a BIO-HAZARD. ALWAYS use “Universal Precautions” when handling any such potentially infectious material. Dispose of properly in accordance with federal, state, and local regulations.

**CLEANING - DISINFECTION - MAINTENANCE**

 **WARNING**  
Always unplug unit from main power outlet before cleaning, disinfecting, maintenance or service.

**Cleaning**

System may be wiped clean using a soft cloth moistened with water and a mild detergent. Do not use excessive liquids or allow liquids to enter control box, pumps, cable connections or other components. Check that system is thoroughly dry before reconnecting power.

**Disinfection**

System should be wiped down with a cold disinfecting solution and a disposable cloth. Do not allow disinfectant solution to remain on product any longer than necessary to ensure proper disinfecting. Before using, test new disinfectants in an inconspicuous surface and check for adverse results. Follow disinfectant manufacturer's instructions for use.

**Removal of Work Surface**

As a convenience, work surface is held securely in place with hook & loop material. If needed, removal is accomplished by simply lifting up slowly.



Lift up slowly and firmly along front edge of work surface (secured with hook & loop material)

**Scheduled Maintenance**

Pressure intake filter should be changed out at a minimum of every two (2) months, or as needed.

Hydrophobic filters should be changed out at a minimum of every three (3) months, or as needed.

All filters simply press into place.



Intake filter removed

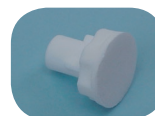

Intake filter



**FILTERS**

**About Hydrophobic Filters**

Both the pressure and suction pumps are fitted with in-line hydrophobic filters. A “hydrophobic” filter allows air to pass through but blocks aqueous (water-based) fluids. The pore size of these filters also traps most common forms of bacteria.

If any aqueous solutions (including bodily fluids) contact the membrane of the hydrophobic filter, the pores will close-down and lock out both liquids and air from passing. This will result in loss of suction and may cause the pump to have difficulty starting. Filters may be fully blocked or only partially blocked depending on how much liquid has entered.

The rated pore size of these filters is 1.0 micron (micrometer) but is effectively ten times smaller than this provided the membrane has not been “wetted”.

**Filter Wetting** - A filter can become “wetted” if the filter membrane comes in contact with alcohol or any other solvent. “Wetting” causes the filter to lose its hydrophobic (water-shedding) characteristics. This causes the filter to allow liquids to pass which would normally be blocked. Hydrophobic filters are incorporated to trap bacteria and help protect pumps from liquids. It is important to replace filters regularly as well as any time they may have become wetted.

**⚠ WARNING**

Always observe Universal Precautions when handling and disposing of hydrophobic filters.

**Replace Pump Filters**

1. Pull tubing loose from hose barbs on filter.
  2. Install new filter by pushing firmly onto filter hose barbs.
- Orientation is important: Refer to diagrams.

Filter life may vary due to several factors. Filters should be checked every three (3) months for the following:

1. Darkening of color (accumulation of particles)
2. Variation in flow rate (decreased flow)
3. Liquid ingress (suction overflow)

If any conditions noted above are observed, replace filters. At a minimum, filters should be changed at least every three (3) months.

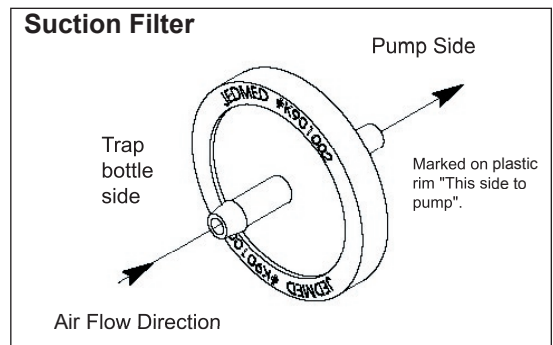
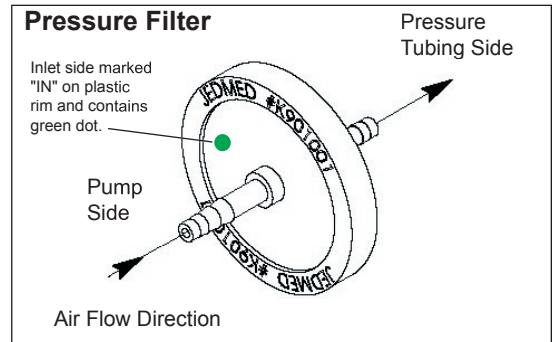

**REORDER INFORMATION**

**Consumables**

Order #	Description
03-5575	Disposable trap canister & lid (pack of 10)
03-5580	Disposable suction tubing (6 ft.)
K901002	Hydrophobic filter (suction)
K903020	Intake filter (pressure)
K901001	Hydrophobic filter (pressure)
<b>Fuses (120V version)</b>	
K011022	T10A Main Power (Bussman #MDA-10, slow) 1-1/4 x 1/4"
K011056	T6.3A Suction / Pressure / Auxiliary (Littelfuse #021506.3HXP, slow) 5 x 20mm
<b>Fuses (240V version)</b>	
Contact JEDMED	

**Replacement Parts**

Order #	Description
K409018	Control Box (120V)
K409019	Control Box (240V)
03-6111	Automatic Pressure/Suction Tubing Hanger
03-6113	Footswitch
03-6115	Remote-Controlled Power Strip
03-6135	K2 handle recharger (otoscope) - on control box
03-6120	K2 handle recharger (otoscope) - free standing

➤ **NOTE**  
 Refer to the assembly drawings located at the back of this manual for replacement parts.

**Contact Information**

For additional information or to order replacement parts contact your Regional Sales Representative or JEDMED Technical Service. Refer to inside of back cover.



**Blank**

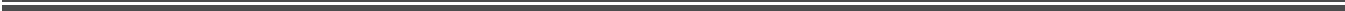

**SPECIFICATIONS**

**Overall Cabinet**

Dimensions	See below	
<b>Weight</b>	<u>In use</u>	<u>Shipping</u>
Laminate version	175 lbs. (80 kg)	200 lbs. (91 kg)
Stainless steel version	190 lbs. (87 kg)	215 lbs. (98 kg)

**Control Box**

Input	115Vac, 60Hz	
Output	115Vac (Controls up to 10 Amps)	
Power	1150W maximum	
Class	Class 1 (3 prong, grounded)	
Dimensions	1.875 x 4.250 x 19.250 inches	(48 x 108 x 489 mm)

**Suction Pump**

Electrical Input	115Vac	4.2amps	60Hz
Vacuum	25.5 in. Hg (max.)		
Flowrate	1.1cfm @ 0 in. Hg		
Dimensions (W x D x H)	7.500 x 5.000 x 8.000 inches	(191 x 127 x 203 mm)	
Weight	14 lbs. (6.4 kg)		

**Pressure Pump**

Electrical Input	115Vac	2.5amps	60Hz
Pressure	35psi		
Flowrate	8 lpm		
Dimensions (W x D x H)	8.000 x 4.000 x 7.000 inches	(203 x 102 x 178 mm)	
Weight	5.0 lbs. (2.3 kg)		

**Trap Canister**

Dimensions (diameter x H)	5.000 x 6.000 inches	(127 x 152 mm)
Capacity	800cc	

**Options**

**Riser with Drawer**

Dimensions (W x D x H)	24.000 x 17.000 x 10.000 inches	(610 x 432 x 254 mm)
Weight	55 lbs. (25 kg)	

**Remote Power Strip**

Dimensions (W x D x H)	1.625 x 2.750 x 15.500 inches	(42 x 70 x 394 mm)
Weight	1.75 lbs. (0.8 kg)	
Current Rating	10 amps (maximum)	

**Flip-Up Writing Shelf**

Dimensions (W x D x H)	14.000 x 14.000 x 0.750 inches	(356 x 356 x 19 mm)
Weight	4.5 lbs. (2.0 kg)	
Weight Limit	15 lbs. (6.8 kg)	

**Footswitch**

Dimensions (W x D x H)	8.000 x 6.000 x 1.500 inches	(203 x 152 x 38 mm)
Weight	1.2 lbs. (0.5 kg)	

**DIMENSIONS**

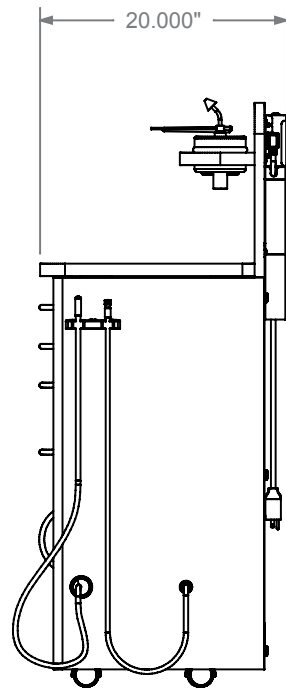
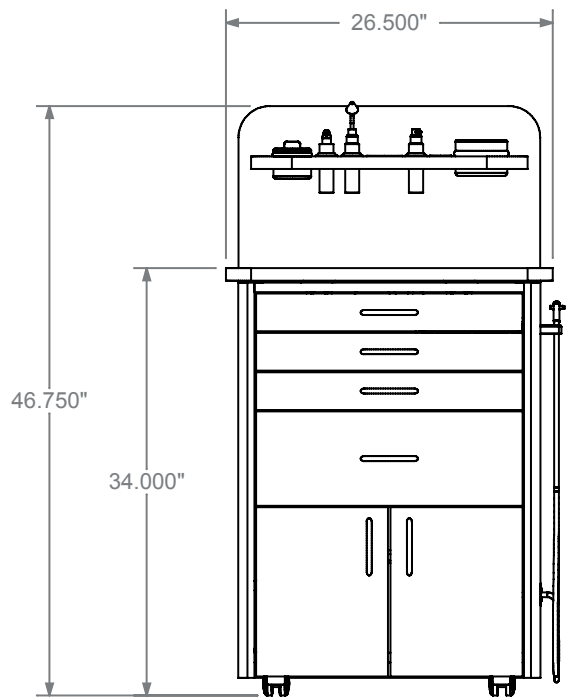
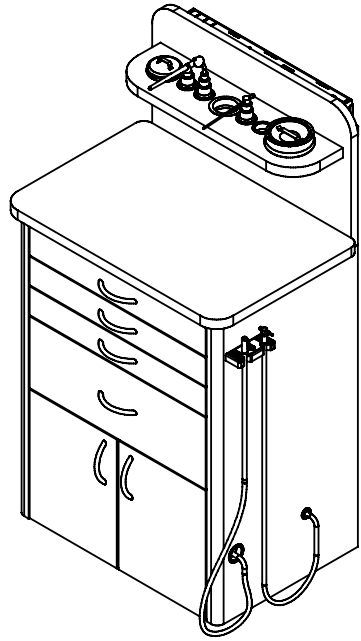



Blank

**SERVICE  
INFORMATION**

**SERVICE INFORMATION**

Service should only be performed by a qualified technician.  
Contact JEDMED for further information.

 <b>WARNING</b>
Always unplug unit from main power outlet before cleaning, disinfecting, maintenance or service.

**Contact Information**

For additional information or to order replacement parts contact your Regional Sales Representative or JEDMED Technical Service. Refer to inside of back cover.



**TROUBLESHOOTING**

Problem / Condition	Possible Cause	Solution
Power light does not illuminate. No functions operate at all.	No AC power at wall receptacle.  Power switch on control box not turned ON.  Power cord unplugged from side of control box.  Fuse(s) blown (main input)	Test power outlet with another device to assure power is available.  Turn power switch ON.  Check to insure power supply and connections are good.  Replace main input fuse(s). (Contact JEDMED)
Pressure or suction pump does not operate. Corresponding pressure or suction indicator does illuminate.	Corresponding pump unplugged from bottom of control box.  Blown fuse (corresponding pump).	Check all pump connections.  Replace fuse (Contact JEDMED)
Pressure pump operates when suction switch is depressed (or vice versa).	Pumps plugged into incorrect AC outlet on bottom of control box.	Plug each pump into proper outlet.
Pressure or suction pump runs continuously; may or may not turn off with main power switch.	Corresponding pump plugged into one of the Switched or Unswitched outlets on bottom of control box.	Plug corresponding pump into proper outlet.
Pressure or suction pump runs continuously.	Cabinet is equipped with automatic Pressure & Suction Hanger and corresponding tubing is not seated in hanger properly.	Fully insert corresponding tubing into automatic hanger so as to properly contact sensing switch.
Suction pump runs, but little or no air comes out.  OR  Pump is difficult to start or will not start and only "hums".	Tubing connection is loose.  Trap canister lid is loose or crack in lid or canister.  Tubing is kinked or clogged.  Hydrophobic (output) filter is clogged.  If equipped with glass trap bottle, overflow valve may be stuck.	Check all tubing connections.  Reset lid or replace canister and/or canister.  Check all tubing for interference.  Replace hydrophobic filter.  Clean overflow protection valve.
Pressure pump runs, but little or no air comes out.  OR  Pump is difficult to start or will not start and only "hums".	Tubing connection is loose.  Tubing is kinked or clogged.  Intake filter is clogged.  Hydrophobic (output) filter is clogged.	Check all tubing connections.  Check all tubing for interference.  Replace intake filter.  Replace hydrophobic filter.

**PUMP CONNECTIONS**

**Suction System**

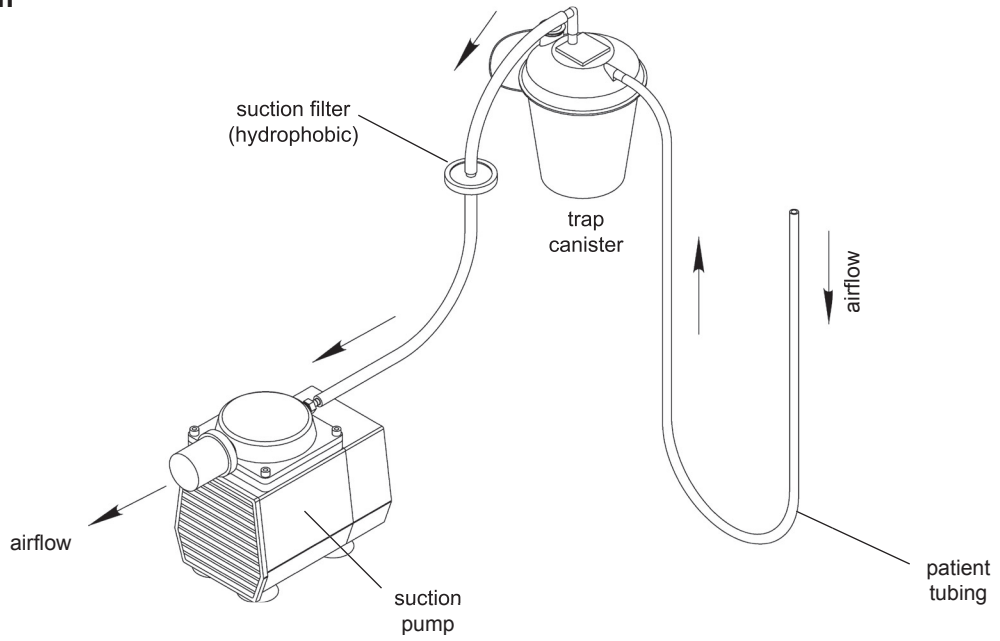

**Pressure System**

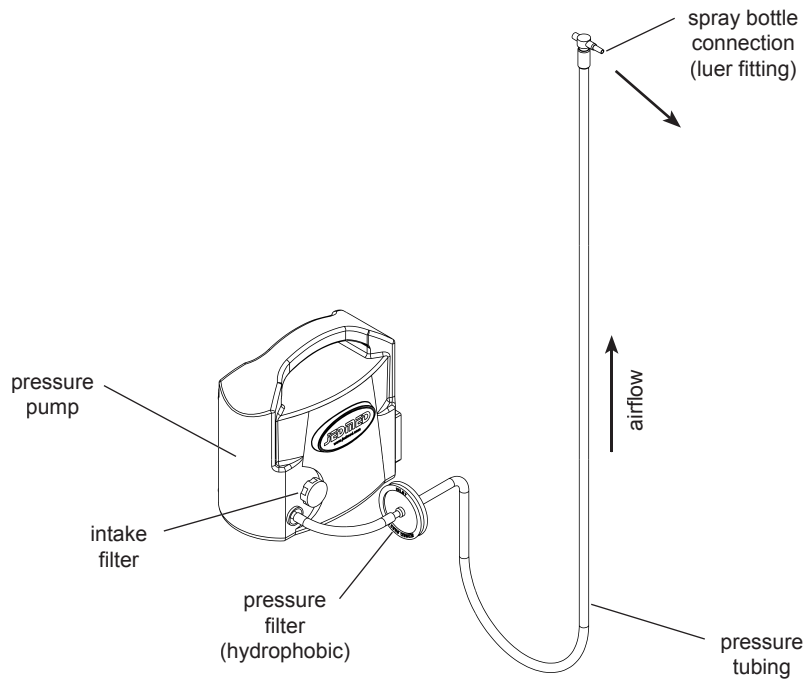

ORDER QTY.	ITEM NO.	ITEM	115V, LX	03-6180	LOT NO.	PART NO.	DWG. NO.	DESCRIPTION
52	K118219	MS: 1/4-20 X 1.250", FL HD, PH, SS	3	-	-	-	-	
51	K118180	MS: 1/4-20 X 1.500", FL HD, PH, SS	-	3	-	-	-	
50	531-PK001	PACKING LIST	1	1	-	-	-	
49	531-AW009	LABEL SERIAL NUMBER	1	1	-	-	-	
48	441-018	BOTTLE SHELF: LAMINATED BLACK, SD	-	1	-	-	-	
47	K300371	TOP: LAMINATED BLACK, SD	-	1	-	-	-	
46	K300370	GROMMET: DV-177	-	1	-	-	-	
45	K300195	GAUZE CONTAINER	-	1	-	-	-	
44	99-0579	NEBULIZER	1	1	-	-	-	
43	48-0180	ATOMIZER (PLASTIC)	1	1	-	-	-	
42	48-0286	POWDER BLOWER	1	1	-	-	-	
41	K701070	LABEL: OVAL F/DV PUMP	1	1	-	-	-	
40	K300244	PRESSURE TIP COLLAR	1	1	-	-	-	
39	KAY5001	GROMMET: 00.750" MOUNTING HOLE, BLACK	1	1	-	-	-	
38	K903019	PUMP: DV. PRESSURE. 120VAC	1	1	-	-	-	
37	K901001	FILTER: 1.0µM, PTFE, 3/16" HOSE BARB	1	1	-	-	-	
36	K907005	TUBING: 3/16" ID., BK SHEATH (2 PCS: 6.00" & 10.0")	11'	11'	-	-	-	
35	KAY16010	HOOK LOOP CINCIN STRAP W/ DRING: 2.0" X 24.0", BLACK, FR	1	1	-	-	-	
34	K120045	FW: 1.000" OD, #10 (0.203") ID, SS, FENDER	2	2	-	-	-	
33	K300587	FOAM PAD F/DV PUMP	1	1	-	-	-	
32	KAY16009	VELCRO LOOP MATL: PSA, 2" WIDE (2 PCS: 2.00" X 16.00")	3'	3'	-	-	-	
31	K910016	COTTON CONTAINER	1	1	-	-	-	
30	K910026	BRACKET: TRAP CANISTER WALL	1	1	-	-	-	
29	K903006	PUMP: 115V, 60HZ	1	1	-	-	-	
28	K136002	FITTING: 1/4" NPT TO 1/4" HOSE BARB	1	1	-	-	-	
27	K136023	MUFFLER: 1/4" NPT, BLACK CAN	1	1	-	-	-	
26	KAY4007	VINYL CAP: 0.375" ID. X 1.500" LONG, RED	1	1	-	-	-	
25	K907012	TUBING: 3/8" OD, 1/4" ID, SMOKE COLOR	6'	6'	-	-	-	
24	K901002	FILTER: 1.0µM, PTFE, 1/4" HOSE BARB	1	1	-	-	-	
23	K907008	TUBING: 1/4" ID., 1/2" OD (2 PCS: 2.50" & 35.50")	3'	3'	-	-	-	
22	K034015	CABLE CLAMP: 0.500"	1	1	-	-	-	
21	K910023	ELBOW: 90°	1	1	-	-	-	
20	K910027	TRAP CANISTER & LID	1	1	-	-	-	
19	K910025	TRAP CANISTER HOLDER (WIREFORM)	1	1	-	-	-	
18	K910001	PRESSURE TIP	1	1	-	-	-	
17	K118114	MS: #6-32 X 1.500", PN HD, PH, SS	2	2	-	-	-	
16	03-6110	ASSY: P/S HANGER (W/O AUTO)	1	1	-	-	-	
15	K041012	PLASTIC SPRING CLIP: 3/8" X 0.132" NYLON	7	7	-	-	-	
14	03-6114	ASSY: MODULAR CABLE WITH PLUG ENDS (8P-10C), BLACK, 4.00"	1	1	-	-	-	
13	KAY03019	DRAWER PULL: BLACK NICKEL, 96MM	6	6	-	-	-	
12	03-5628	DRAWER LINER	3	3	-	-	-	
11	KAY16006	LOOP MATL: 1.00", PSA, WHITE (8 PCS: 1.00" X 2.50")	2'	2'	-	-	-	
10	KAY16007	ASSY: LOW VOLTAGE CONTROL BOX (LVCE)	1	1	-	-	-	
9	K409018	CORD CHASE HOUSING	1	1	-	-	-	
8	K300585	MS: #6-32 X 0.500", PN HD, PH, SS	2	2	-	-	-	
7	K118036	SMS: #8 X 0.500", TR HD, PH, SS, B0	18	18	-	-	-	
6	K042040	POWER CORD: 12.00", 120V, IEC320 RIGHT ANGLE	5	5	-	-	-	
5	KAY15002	GROMMET: 1.500" MOUNTING HOLE	1	1	-	-	-	
4	K300241	CORIAN BOTTLE SHELF: LX (SPECIFY COLOR)	3	3	-	-	-	
3	K300240	CORIAN TOP: LX (SPECIFY COLOR)	1	1	-	-	-	
2	K909020	CABINET SHELL	1	1	-	-	-	

### BILL OF MATERIALS

**JEDMED**  
INSTRUMENT COMPANY  
11500 JEDMED COURT  
MIRAMONTE, CA 91764-0079

QUALITY NOTICE  
ALL MATERIAL AND WORKMANSHIP TO BE SUITABLE FOR MEDICAL ENVIRONMENT'S APPLICATIONS AND ANY UNAUTHORIZED REPRODUCTION OR USE IS STRICTLY PROHIBITED.

TITLE: **ASSY: CLASSIC CSC (ALL VERSIONS)**

SHEET SIZE: **11 X 17 (B)**

DRAWING # **531-AY010**

REV **0**

DRAWN BY **M. GODFREY**

DATE **11-19-2010**

APPROVED BY

PART # **MULTIPLE**

DIMENSIONS  [mm]  in

SHEET **1** OF **2**

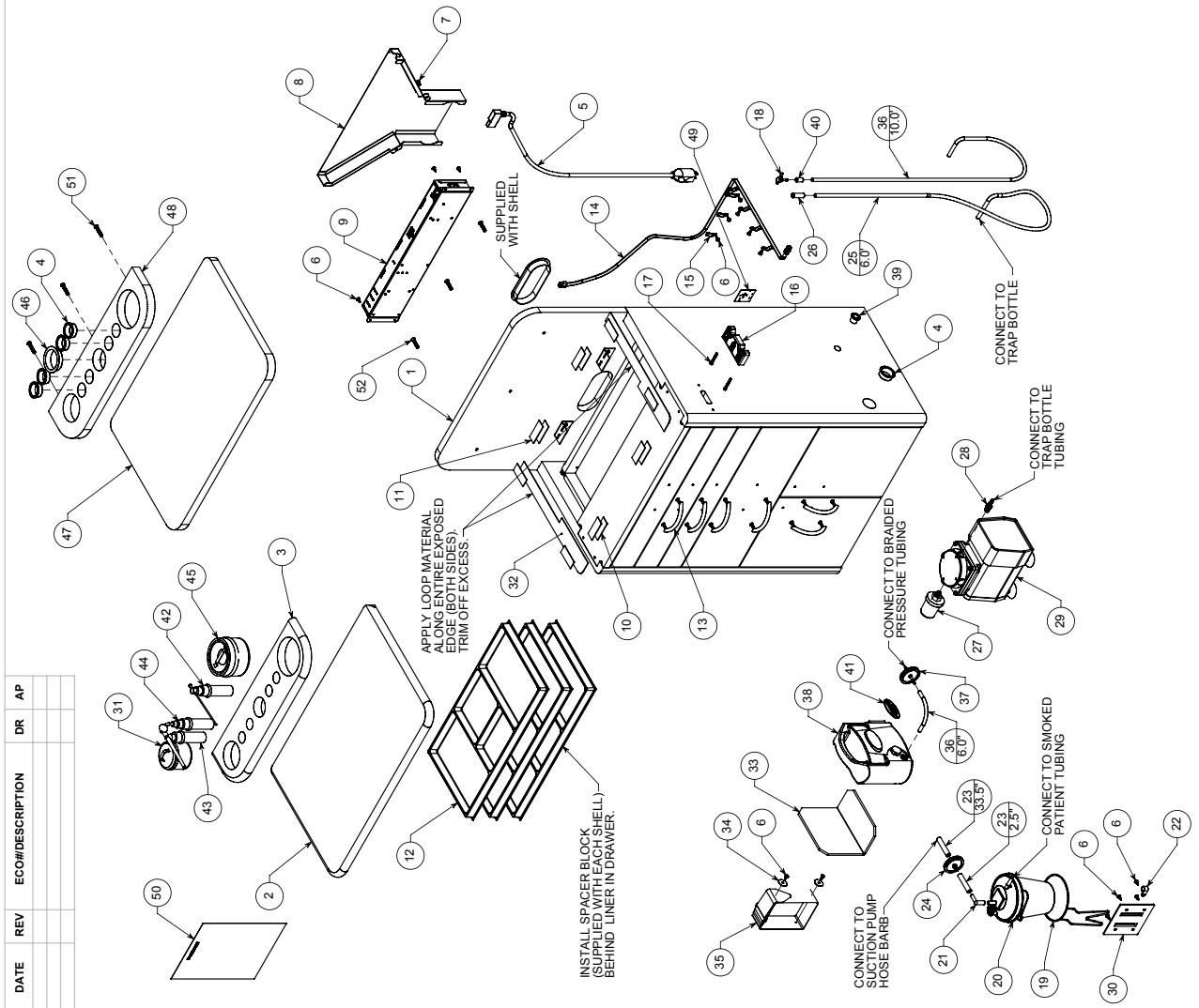

DATE	REV	ECO#/DESCRIPTION	DR	AP



Blank

# **NOTES**



**7740 Records Street  
Indianapolis, IN 46226**

**(317) 545-6196 • 800-428-1610**

**Fax: (317) 543-3289 fax**

**E-mail: [customerservice@anthonyproducts.com](mailto:customerservice@anthonyproducts.com)**

**Website: [www.anthonyproducts.com](http://www.anthonyproducts.com)**